

Stainless Steel  
Micro-Mesh

# GUTTER GUARD

## DIY KIT



**FREE  
GUTTER  
GUARD  
BRUSH\***

by registering for your  
**25 year warranty!**

*\*Shipping and handling  
not included*

[raptorgutterguard.com/registration](http://raptorgutterguard.com/registration)

## RECOMMENDED TOOLS

*Not Included*



**GLOVES**



**SAFETY  
GLASSES**



**TIN  
SNIPS**



**DRILL**



**EXTENSION  
LADDER**

*With Standoff*

## INCLUDED

- Gutter Guard
- Self-tapping screws

**RAPTOR**  
GUTTER GUARD



Proper installation is very important to ensuring optimal performance from your gutter guards.

We encourage you to review the full guide prior to installing.

# INSTALL GUIDE

SCAN HERE



**START YOUR INSTALL  
JOURNEY HERE!**

[raptorgutterguard.com/how-to-install](http://raptorgutterguard.com/how-to-install)

Gutterglove® *cares* **NEED HELP?**

[raptorgutterguard.com/contact](http://raptorgutterguard.com/contact) | 844.359.7689 | M-F 8am-7pm CST

DO IT  
RIGHT.  
DO IT  
ONCE.®

## IMPORTANT INFORMATION

### BEFORE YOU BEGIN

#### **SAFETY IS OUR #1 PRIORITY.**

During Installation we recommend that you...

- Wear gloves & safety glasses.
- Use an extension ladder and ladder standoff for stability.
- Make all cuts and bends to the gutter guards on the ground.

#### **ALSO MAKE SURE TO:**

- Obey local building codes.
- Check to see if your roofing material is adhered to your underlayment. Do not pry up your shingles or tear your underlayment. Use alternate installation method.
- Complete the "Do it Right, Do it Once Install Check List". See page 16.



#### **FREEZING CONDITIONS**

If you live in an area that is prone to freezing, the following issues can occur with any gutter guard.

#### **ICICLES & ICE DAMS**

Icicles and ice dams may form on your gutter during freezing conditions. Ice dams can cause water to leak back into your home. Icicles can break and cause serious bodily harm and injury. Properly installed, operated and maintained heating elements on your roof and gutter can melt icicles and ice dams. Use a local licensed electrical contractor in good standing for installing any heating element products.

#### **SNOW MELTING**

Snow melt may result in water runoff from your roof which can refreeze on the ground below creating a potential slipping hazard.



## INSTALL OVERVIEW

### **PRE-INSTALL**

The Basics .....	2
Preparing Your Gutters.....	3
Determining Roof Slope/Pitch .....	4
Choose Your Install Method .....	5
Your Secure Method .....	7

### **INSTALLATION**

Important Steps .....	7
Typical Install Guide .....	8
Cutting & Joining Sections .....	10
Inside Corners .....	11
Outside Corners .....	12
End Caps .....	12
Bending The Mesh .....	13
Removing The Gap.....	14

### **EXTRAS**

General Customization.....	15
Do It Right. Do It Once. Checklist.....	16
Maintaining Your Gutter Guards.....	17
Warranty Information .....	18



#### **DO NOT RETURN THIS PRODUCT**

Please contact our Customer Experience Team before returning any product. If you experience problems with your installation, our team will be happy to assist you.

[raptorgutterguard.com/contact](http://raptorgutterguard.com/contact) | 844.359.7689 | M-F 8am-7pm CST



# THE BASICS

## IN YOUR KIT

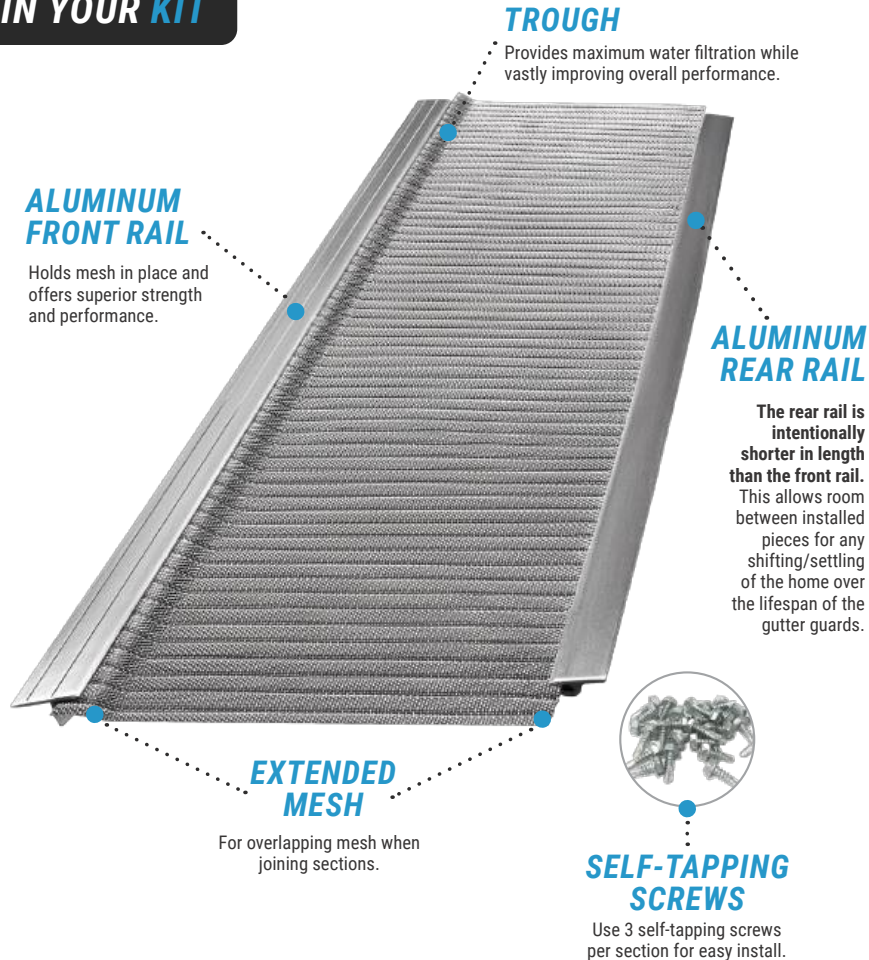

**NEED HELP? CONTACT OUR CUSTOMER EXPERIENCE TEAM.**  
raptorgutterguard.com/contact | 844.359.7689 | M-F 8am-7pm CST

**DO IT RIGHT. DO IT ONCE.®**

LET'S GET STARTED →

## 1 PRE-INSTALL

### PREPARING YOUR GUTTERS



#### CLEAN YOUR GUTTERS

Clean all leaves, pine needles, and other debris from your gutters and downspouts.



#### TAKE CARE OF REPAIRS

Complete any repairs to your gutters and downspouts as needed.

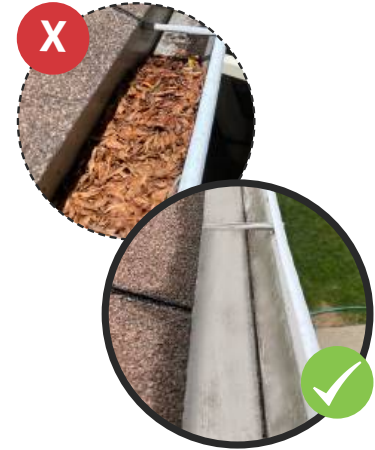

## 2 PRE-INSTALL

### DETERMINING ROOF SLOPE/PITCH

Determine the slope/pitch of your roof.

If the roof is **mildly to moderately pitched** (1–6 pitch), you can install the gutter guards at the same slope (5°–25°).

If the roof is **steeply pitched** (7 or greater), you will need to use one of the bending methods shown on page 14 to achieve the recommended installation slope (5°–10° or 1–2 pitch) of the gutter guard.



**NEED MORE INFORMATION ON FINDING THE SLOPE FOR YOUR INSTALLATION?**

← Check out this video.

More information on determining roof slope on page 4 →

# DETERMINING ROOF SLOPE/PITCH CONTINUED

## MILD/MODERATE ROOF SLOPE/PITCH

ROOF & GUTTER GUARD

SLOPE  
5°-25° OR PITCH  
1-6

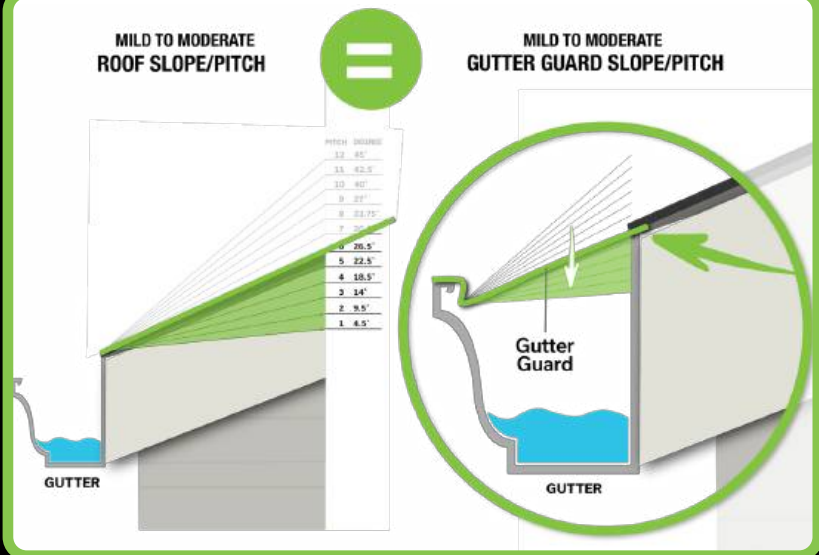

## STEEP ROOF SLOPE/PITCH

ROOF  
SLOPE  
26°-45° OR PITCH  
6-12

GUTTER GUARD  
SLOPE  
5°-10° OR PITCH  
1-2

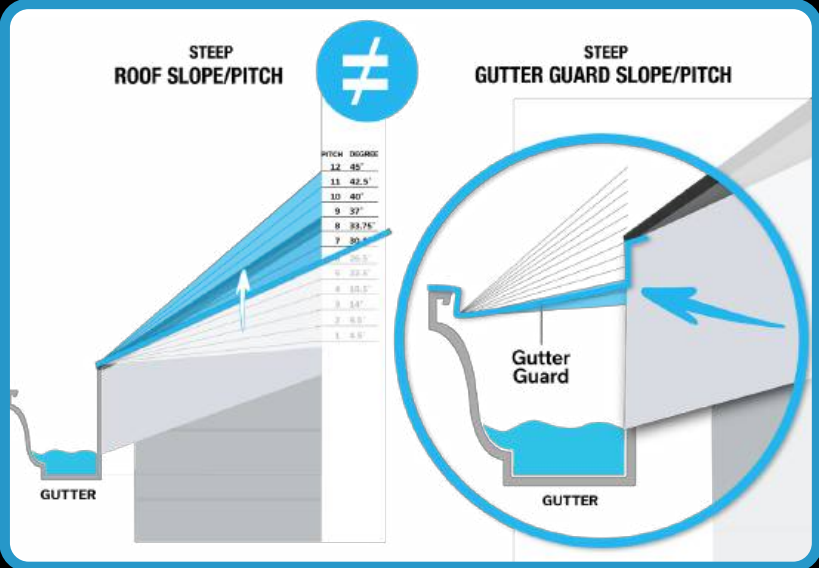

You will need to use one of the bending methods shown on p. 13 to achieve the recommended installation slope.

## 3 PRE-INSTALL

## CHOOSE YOUR INSTALLATION METHOD

Determine the method that works best for your gutter-to-roof configuration.

### TRADITIONAL INSTALLA-

### METHOD A

### UNDER THE ROOF INSTALLATION

Slide gutter guard under roof shingles.

**IMPORTANT:** If your roofing material is adhered to your underlayment, do not use this method. Use one of the bending methods instead. (See page 13)

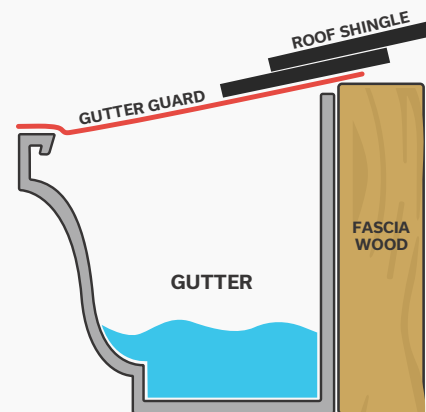

### METHOD B

### BELOW THE ROOFLINE INSTALLATION

Bend mesh either up or down, then fasten to the gutter, drip edge or fascia with screws. (See page 13)

**NOTE:** This method works on any scenario when you cannot install directly under the shingles, tile, etc.

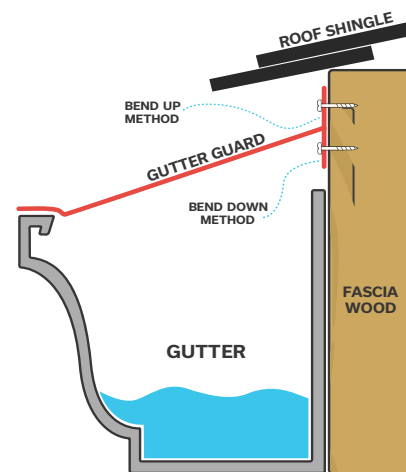

See more install methods on page 6



### METHOD C

#### STEEP ROOF INSTALLATION

Slide it under the roof shingle, if it causes the roof shingle to ramp up or your roofing material is adhered to your underlayment, see Method B and bend the mesh up or down and fasten to the gutter, drip edge or fascia with screws. (See page 13)

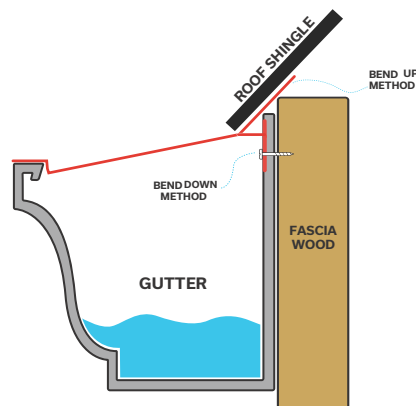

### METHOD D

#### ALTERNATIVE INSTALLATION METHOD

If the gutter guard isn't wide enough to slide under the roof shingles, put 3 screws in the back of the gutter, drip edge, or fascia to hold up each section. Secure the gutter guard to the front lip of the gutter with screws.

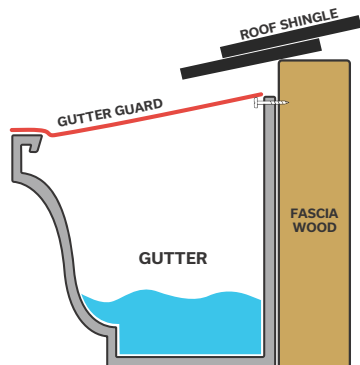

*\*\*If you need additional screws, please give us a call at 844.359.7689.*

## 4 PRE-INSTALL

### CHOOSE YOUR SECURING METHOD

We've designed Raptor Gutter Guard® with a simple installation in mind. Manageable sections slide right into place. Then, simply screw them on. Most homes are completed in an afternoon.

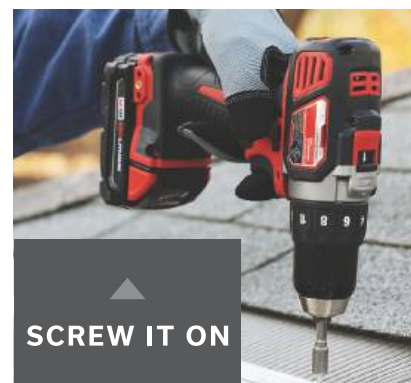

#### SCREW IT ON

- ☐ Use 3 self-tapping screws per section.
- ☐ Pre-drilling not required.



### IMPORTANT: DON'T MISS THESE STEPS!

Rainwater may run over the front lip of your gutter if these steps are overlooked.

#### REMOVE THE GAP

Front frame of the gutter guard should be flat against the front lip of your gutter.



**PUSH DOWN FLAT TO REMOVE GAP.**

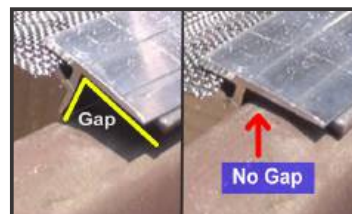

#### THE TROUGH

The trough (see page 2) should be at least 1/8" of an inch below the lip of the gutter. This adjustment may need to be made on steeply pitched roofs or gutters that are hung 1 inch or lower below the roofline.

**PUSH DOWN FIRMLY WITH YOUR FINGERS**



### ! IMPORTANT NOTE FOR ALL INSTALL METHODS

#### AVOID ROOF RAMPING

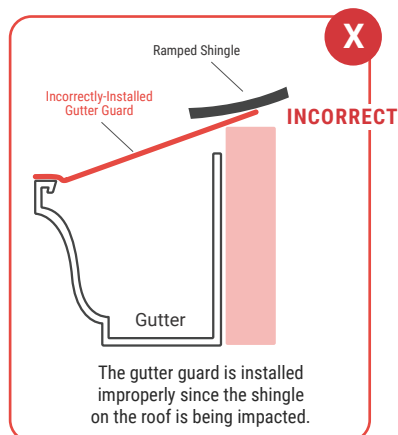
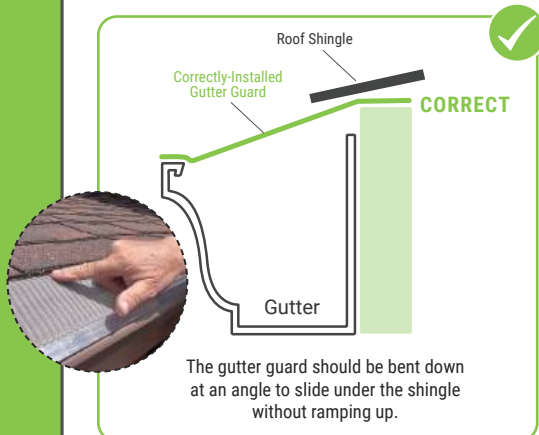

# TYPICAL INSTALLATION

This section provides general guidance on getting started and working your way through an install. Remember to check pages 4 – 6 to determine the installation method that will work best with your gutter-to-roof scenario.



## STARTING OUT

We recommend starting at an inside corner. If you do not have one, start by the downspout. Otherwise, start at the end of the gutter.



## FOR CUTTING SECTIONS

Use a new, or freshly sharpened, pair of tin snips for cutting the aluminum rail. A pair of commercial grade scissors will work for cutting the mesh.



## DID YOU CHOOSE METHOD B OR C?

### BENDING THE MESH (If Necessary)

Depending on the install method you chose on pages 5-6, you may need to bend the mesh up or down to achieve the recommended slope of the gutter guard (5°-25°). See page 13 for further instruction on how to bend the mesh.

If you chose method A, you can skip this step.



## FOR JOINING SECTIONS

For joining sections together- lay one end of the mesh so it overlaps directly over the other section.



## SCREW INSTRUCTIONS

If screwing it down, use the guides on the front rail to place the screw. Fasten with 3 screws for each section of gutter guard.

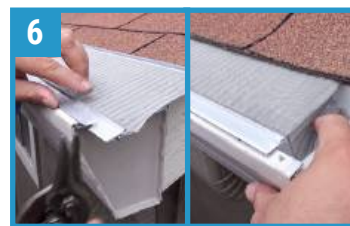

## FOR MAKING THE END CAP

For creating an end cap, trim off a few inches from the front and back rail. You will need to expose enough mesh to cover the gap at the end of the gutter. Push the mesh into the gutter end to seal the space.



## FOR CORNERS

Refer to pages 11-12 for installing at an inside and/or outside corner.





## CUTTING & JOINING SECTIONS

### CUTTING SECTIONS

Use a sharp pair of tin snips to cut through the aluminum rail and the mesh. Commercial-grade scissors can also be used to cut the mesh.



#### HAVING TROUBLE?

Check out this video to see our recommended method for cutting the rails.

### JOINING SECTIONS

Each section has mesh that extends past the aluminum rail. Lay one end of the mesh so it overlaps directly over the other section.

*Note: The rear rail will have more exposed mesh than the front rail. This is intentional.*



### INSIDE CORNERS

Slide one piece so that it is flush with the back corner. On a second piece, trim back the aluminum rails by approximately 1 inch. Tuck the exposed mesh down inside the gutter adjacent to the piece already in place.



### RAINWATER DIVERTERS



Roof valleys can cause excessive rain water and debris build up creating challenges for all gutter guards. Rainwater diverters help hold debris back and away from the gutter guard.

Get more information and purchasing details at [RainwaterDiverters.com](http://RainwaterDiverters.com).





## END CAPS & OUTSIDE CORNERS

### OUTSIDE CORNERS

Let the piece run long to the end of the gutter. Bend down the back aluminum rail into the gutter. Mark the adjoining piece at the same angle as the roof edge, then use tin snips to cut away the outlined piece. Once cut, fit it into the outside edge so that it's aligned with the opposite piece.



### END CAPS

Trim back the aluminum rails and tuck the exposed mesh down into the gutter. Make sure the entire gutter end is sealed.



## BENDING THE MESH

### BENDING THE MESH

Bending the mesh allows you to fit the gutter guard on any gutter-to-roof scenario.

#### WHAT YOU'LL NEED:

- ❑ Two - 1"x2" boards that are 4.5' long with square edges
- ❑ Two - 4" clamps
- ❑ Measuring Tape
- ❑ Permanent Marker
- ❑ Gloves



#### 1 MEASURE & MARK

Once you have all materials gathered, measure and mark where the bend needs to be on the mesh based on your gutter-to-roof scenario.



#### 2 CLAMP MESH

Clamp the gutter guard between two 1"x2" boards to hold it in place.



#### 3 BEND MESH

Use the leverage from the clamp and/or boards to bend the mesh along the line you've marked.

Note: Bend the mesh either up or down depending on the type of roof you have.



#### 4 INSTALL

Making sure the mesh is bent at an angle that aligns with your roof configuration, install the gutter guard per the best installation for your gutter-to-roof scenario. (See pages 5-6.)





## REMOVING THE GAP



### IMPORTANT: DON'T MISS THESE STEPS

Rainwater may run over the front lip of your gutter if these steps are overlooked

## REMOVING THE GAP



### PUSH TROUGH DOWN

Make sure gutter guard sits flat on gutter lip. Mesh trough should be at least 1/8" below gutter lip. Use fingers if necessary to push mesh trough down.

### REMOVE THE GAP

There should be no space between the front rail and the gutter lip when you install the gutter guards.



NEED HELP?

raptorgutterguard.com/contact | (844) 359-7689 | M-F 8am-7pm CST

## CUSTOMIZATION OPTIONS

Below are several examples of how to customize an install by bending the mesh or notching the gutter guards.



### HAVING TROUBLE?

Scan this QR code to see our how-to videos for each roof/gutter configuration

#### LOW-HANGING GUTTER



#### STANDING LOCK METAL SEAM



#### FLAT ROOF



#### SOFT METAL ROOF



#### VILA TILE ROOF



#### WOOD SHAKE ROOF



### MORE CUSTOM INSTALLS



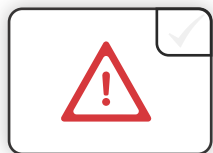

### **FOLLOW ALL SAFETY GUIDELINES**



### **COMPLETE THE PRE-INSTALLATION PLAN**

See pages 3-7.

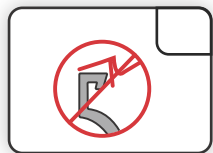

### **ACKNOWLEDGE IMPORTANT INSTALL STEPS**

See page 7.

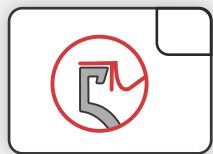

### **INSTALL GUTTER GUARDS**

See pages 8-14.

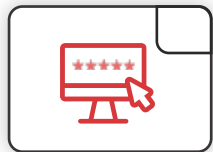

### **REGISTER YOUR PRODUCT & LEAVE A REVIEW**

Receive a free "The Gutter Guard Brush" when you register your product. See page 17.



### **LEARN HOW TO MAINTAIN YOUR GUTTER GUARDS**

See page 17.

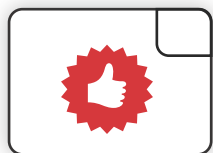

### **FOLLOW @RAPTORGUTTERGUARD**



NEED HELP?

raptorgutterguard.com/contact | (844) 359-7689 | M-F 8am-7pm CST

## **MAINTAINING YOUR GUTTER GUARDS**

Your new gutter guards are designed to be easy to maintain. Follow the tips below for easy maintenance:



### **GET YOUR FREE GUTTER GUARD BRUSH**

by registering for your 25 year warranty!

\*Shipping & handling not included

SCAN HERE



### **PERIODICALLY INSPECT**

Check your gutter guards for any debris that may not have blown off, particularly where two sections of your roof come together (valley) or in areas that are protected from wind.



### **BRUSH OFF DEBRIS**

We created "The Gutter Guard Brush" for just this purpose. Screw the brush on the end of an extension pole, then from the ground, reach up and brush off the debris. Be sure to wear protective eye wear.



Get more information at [TheGutterGuardBrush.com](http://TheGutterGuardBrush.com)



## 25 YEAR LIMITED PARTS WARRANTY

**GUTTERGLOVE, INC.** (herein referred to as GGI) warrants to the original purchaser that its specially designed Raptor Gutter Guard will be free from defects in manufactured parts and agrees that it will, at its option only, either repair the defect or replace the defective part thereof with a new or reconditioned equivalent. This Limited Warranty is valid for 25 (twenty-five) years for parts only and does not include cost of labor for re-installation. In coastal areas, warranty is reduced to 5 (five) years for parts only. "Coastal areas" is defined as anywhere within 5 (five) miles of the coast. Shipping costs will be absorbed by the purchaser of Raptor Gutter Guard. The above named item is subject to the following terms and conditions. No other warranty is expressed or implied in this Limited Warranty.

**COVERAGE EXCLUSIONS AND LIMITATIONS:** The above mentioned warranties are void if any of the following conditions occur: Improper installation; Settlement of building structure; Structural shrinkage or distortion of structure (Example: warping of roof or gutter over time, etc.); Vandalism; Hail; Fire; Tornado; Windstorm; Earthquakes; Lightning; Protective liquids or any type of roof preservation product applied to roof tops to extend the life of a roof; Maintenance procedures are not followed properly; Tree sapping on mesh; Insect/bird droppings on mesh; Accidental damage; Acts of God; Misuse or abuse of the gutter guard; Mildew accumulation; Paint overspray; Moss accumulation; Impact of foreign objects; Caustic atmospheric conditions (Example: Acid rain, harmful chemicals, salt spray, etc.) or any other causes beyond the control of GGI. It is the owner(s) responsibility to unclog the mesh in the event it gets clogged. Icicles can form, and ice can form on top of Raptor Gutter Guard in extreme cold weather where snow is present.

GGI's obligation under this warranty shall at no time exceed

the original purchase price of this product at time of sale, but not for installation or re-installation costs. This warranty covers only Raptor Gutter Guard and does not cover the gutter or any part of the building structure.

GGI reserves the right to withdraw this warranty from the market at any time. Any and all warranties in effect at the time of removal will not be affected by the withdrawal and will remain in effect until their expiration. This warranty is non-transferable.

GGI will not be liable to you or any subsequent owner(s) for a breach of any written or oral express warranties, such as those given to you by a contractor, sub-contractor or installer. Any implied warranties imposed by law, such as the implied warranties of merchantability and fitness for a particular purpose are limited in time to the duration of this ex-press warranty. GGI shall not be liable for any consequential damages for breach of any express, written, oral, or implied warranty on any Raptor Gutter Guard. Your exclusive remedy shall be repair or replacement solely at GGI's option, only on terms stated in the warranties.

**ACTIVATION OF WARRANTY:** This warranty becomes effective at time of purchase. Retain this document with original purchase receipt. Failure to do so will render this warranty null and void.

**CLAIMS PROCEDURE:** Any claim made hereunder must be presented to GGI within the warranty period within a reasonable period of time after discovering the defect. The claim should make reference to original date of installation, the purchaser's name, address, phone number and a copy of the original receipt.

**CONTACT GUTTERGLOVE AT (844) 359-7689.**



### DO NOT RETURN THIS PRODUCT TO THE STORE

Please contact our Customer Experience Team before returning any product. If you experience problems with your installation, our team will be happy to assist you.

SCAN HERE



[raptorgutterguard.com/contact](http://raptorgutterguard.com/contact) | (844) 359-7689 | M-F 8am-7pm CST

